

*Veranda 3x 34 mm*

<b>Position</b>	<b>Name</b>	<b>B width mm</b>	<b>H Height mm</b>	<b>L Length mm</b>	<b>Quantity</b>
<b>003.</b>	<b>Foundation treated bearer</b>	-	-	2813	3
<b>003a.</b>	<b>Foundation treated bearer</b>	-	-	1000	2
<b>008.</b>	<b>Floorboard (Tongue and Groove)</b>	-	-	<b>1260</b>	3,5 m2
<b>017.</b>	<b>Various wall log</b>	<b>34</b>	<b>135</b>		
<b>072.</b>	<b>Scarf details for veranda</b>	-	-	810	4
<b>073.</b>	<b>Décor (strip) for veranda</b>	-	-	1270	2
<b>073a.</b>	<b>Décor (strip) for veranda</b>	-	-	1000	2
<b>073b.</b>	<b>Décor (strip) for veranda</b>	-	-	130	2
<b>011.</b>	<b>Metal corners</b>	-	-	-	4

# Veranda 3x

34x135 mm

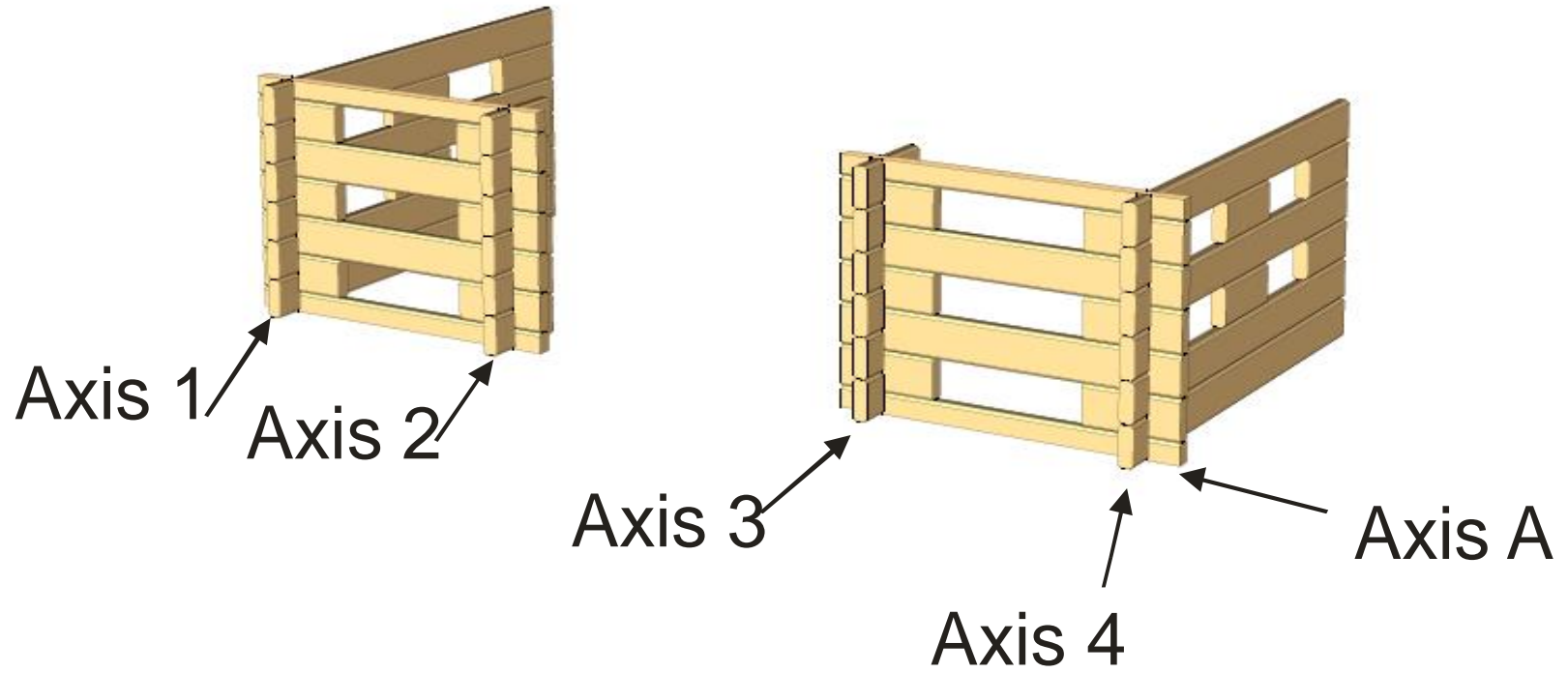

# Veranda 3x

34x135 mm

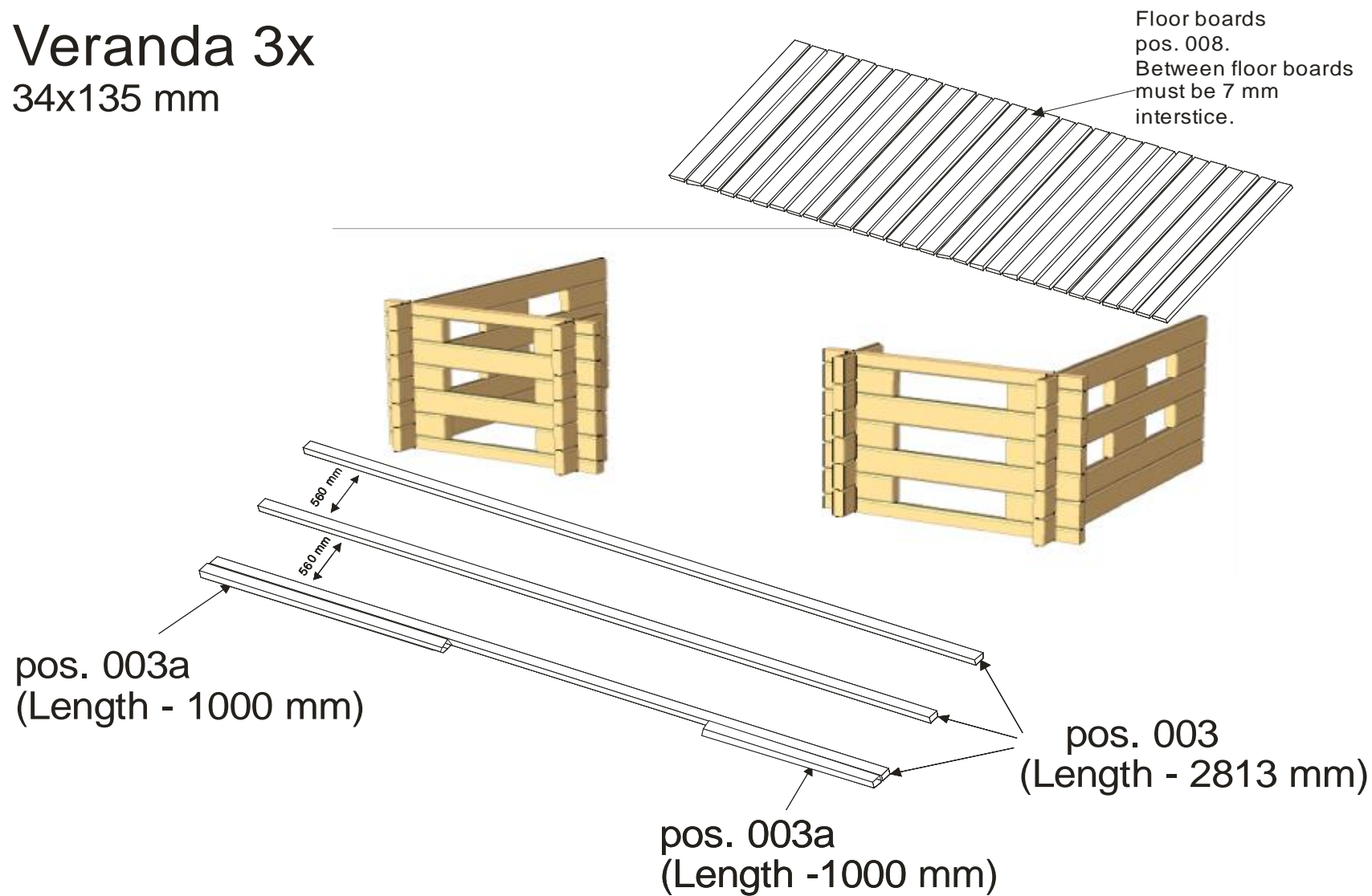

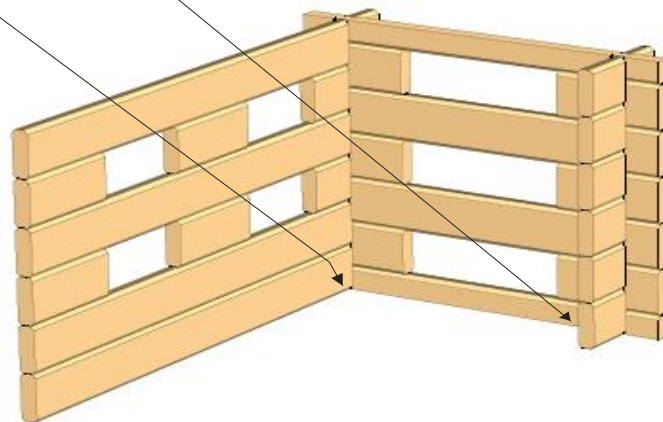

**These metal corners pos. 011. must be fixed as shown on the picture.**



**This metal corner pos. 011. must be fixed as shown on the picture.**

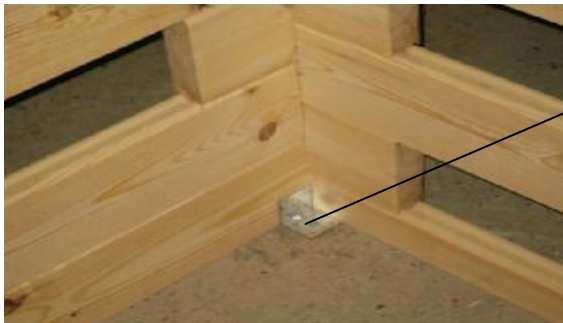
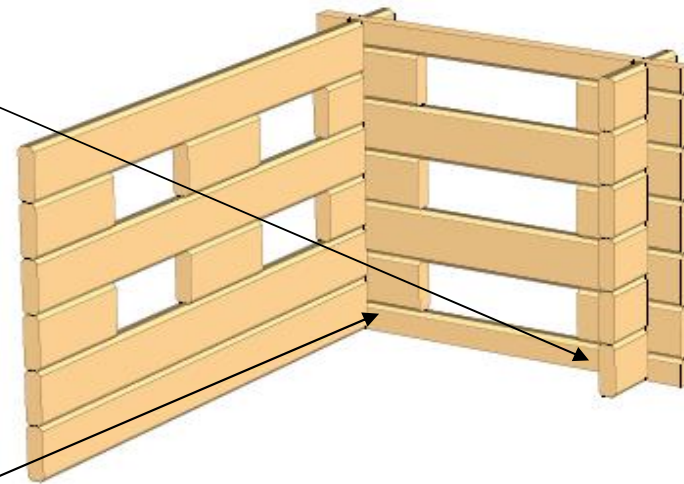

**This metal corner pos. 011. must be fixed in the corner as shown on the picture.**

# Wall on axis 1

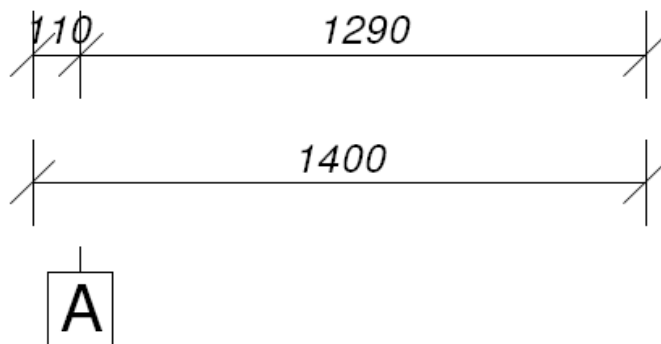
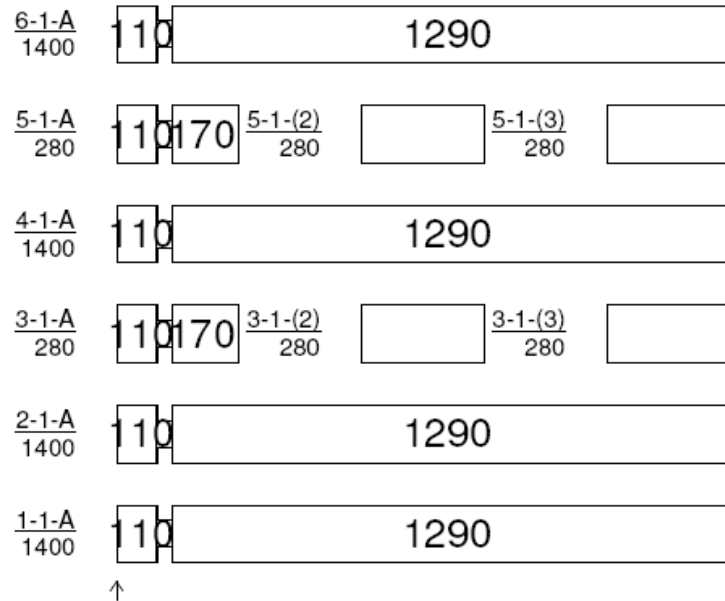

# Wall on axis 2

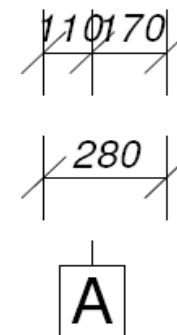
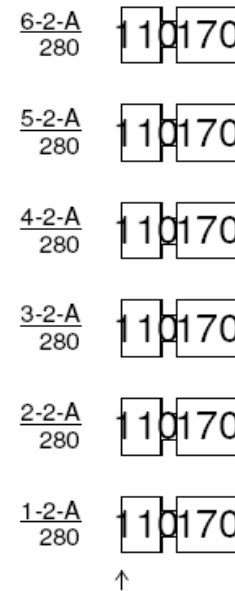

## Wall on axis 3

$\frac{6-3-A}{280}$  110 170

$\frac{5-3-A}{280}$  110 170

$\frac{4-3-A}{280}$  110 170

$\frac{3-3-A}{280}$  110 170

$\frac{2-3-A}{280}$  110 170

$\frac{1-3-A}{280}$  110 170

↑

110 170

280

A

## Wall on axis 4

$\frac{6-4-A}{1400}$  110 1290

$\frac{5-4-A}{280}$  110 170  $\frac{5-4-(2)}{280}$   $\frac{5-4-(3)}{280}$

$\frac{4-4-A}{1400}$  110 1290

$\frac{3-4-A}{280}$  110 170  $\frac{3-4-(2)}{280}$   $\frac{3-4-(3)}{280}$

$\frac{2-4-A}{1400}$  110 1290

$\frac{1-4-A}{1400}$  110 1290

↑

110 1290

1400

A

# Wall on axis A

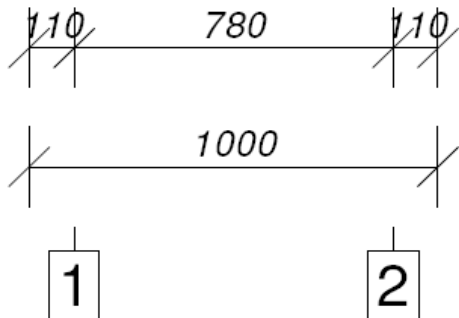
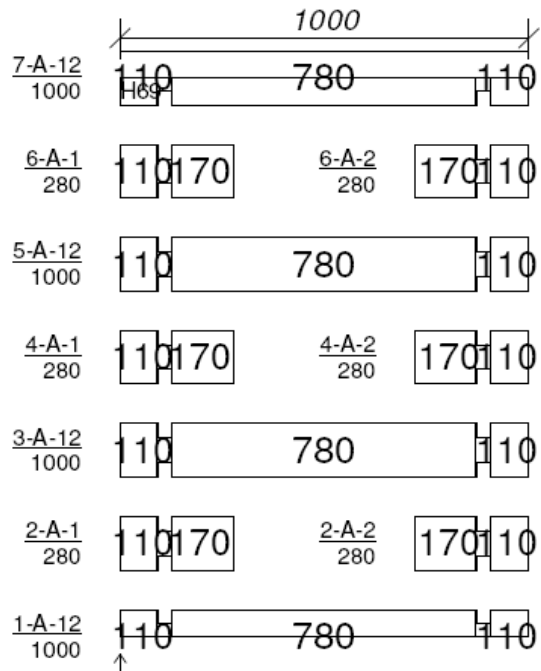

# Wall on axis A

